



# Metron

Engineering for Life

|| [www.metronsa.eu](http://www.metronsa.eu)

**ALUMIL** Group



## introduction - history

[www.metronsa.eu](http://www.metronsa.eu)

The idea of creating an automation company was born in 1988 by a group of engineers that was working for the construction company "Horizon". At that time, Horizon was responsible for the construction of a car control center which had automatic doors for buildings as part of the project specifications. The increased cost stimulated this group of engineers to manufacture on their own automatic doors for buildings from scratch based on their self-confidence and mentality "Yes, we can".

The project was successfully completed, however, the market conditions transformed the initial idea towards the creation of automatic doors for lifts. Hence, in 1995 Metron was established from Mr. Ioannis Sandros in a small town named Nigrita where they were built production facilities less than 500 m<sup>2</sup>. In 2000, Mr. George Milonas (president of Alumil Group) decided to invest in Metron's know-how and human capital, therefore, Metron was integrated to Alumil Group with the relative share restructuring. After the initial investment Metron moved to the Industrial Area of Serres, where it was equipped with the latest machinery tools.

Product-wise Metron started the production of folding doors, Bus type, a product that gained rapidly big market share in Greece and in Europe, while at the same time gradually Metron expanded its product range with Automatic Doors, Cabins and Semi-Automatic Doors. In 2008, after the successful completion of continuous investments Metron began designing and manufacturing of Complete Lift Solutions. In 2009, Metron manufactured the first hydraulic system and very quickly traction solutions with or without machine room were also introduced to the arsenal.

The company due to the Greek crisis expanded dynamically the exports in most European countries, in Africa, Latin America, Arabian Gulf etc. and as a result is now exporting 85% of its total annual sales.

New products and services are being developed and updated continuously every day, always with the same identity elements:

- Applied Advanced Technology
- Reliability as people, as company, as product
- Unique Design
- Competitiveness



# corporate values

www.metronsa.eu

In Metron together with our partners we build our brand identity on 3 axes:

## 1. People

The foundation based on which Metron is built is its human capital, Metron people. Either people on the production lines or people at the front line. All are considered as Metron's biggest competitive advantage and continuous source of inspiration now and always. Respect, ethos, team spirit and the ability of alignment are timeless values and they secure excellent level of customer service and support.

## 2. Integrity

Metron aims at long-term trustworthy partnerships through the establishment of

win-win decisions for our partners, the final users of our products, our employees and Metron itself.

## 3. Creativity

Customer satisfaction, for us, is the result of constant improvement and innovation. We are who we are, not because of being the best, but for being the ones who hear their customers, value their opinions, the ones who want to improve themselves, to make one step forward. We are competitive because we care for our own future and the future of our partners.



# facilities

www.metronsa.eu

**Metron's** headquarters in the Industrial Area of Serres in Greece are located in a privately owned area of 36.000 m<sup>2</sup>, including 15.000 m<sup>2</sup> of production facilities and additional 1.000 m<sup>2</sup> of administration offices and research, training and development buildings. For the manufacturing of its products, characterized by increased technical and aesthetic requirements, the company invests constantly not only in modern mechanical equipment but also in highly educated and trained workforce.

Aiming to improve the overall experience that our solutions offer, new products and services are being developed and updated every day, always with the same **Metron** characteristics:

- "Useful advanced technology" as a client-oriented perception of advanced technology use.
- Reliability, both as a product characteristic and as a corporate practice.
- Distinctive design
- Competitiveness, perceived as the best value-for-money relationship.





# Alumil Group

In 1988 Mylonas family founded an aluminium profile factory outside of Kilkis, in order to supply the local market. Over the last 20 years this small unit has transformed into the biggest private aluminium extrusion company in southeastern Europe. Today, with more than 20 years of experience, Alumil is one of the most advanced companies globally in the design and production of aluminium extrusion products with state-of-the-art production lines in all its factories.

Alumil's most important asset is its Human Resources.

## Today, In southeastern Europe Alumil is:

- No1 extruder for aluminum profile systems
- No1 in sales
- No1 in exports
- No1 in development
- No1 in investments
- No1 in creating new jobs
- No1 in industrial area

## The biggest retail network in South-East Europe

Over the past 15 years Alumil has

More than 2000 employees in 25 different countries continue to lead Alumil into new markets. Based on extensive experience and expertise of our people, we try to "build excellence every day".

ALUMIL S.A. is the largest private industry in southeastern Europe, who produces and supplies aluminum profile systems, and is amongst Europe's accredited suppliers of architectural aluminum systems.

developed and operates successfully a retail network of over 50 branches (Sales & Distribution Stores-SDS) in South-East Europe on key categories of building products. Aluminium systems are the core product category. The national retail networks in each country (Romania, Bulgaria, FYROM, Albania, Poland, Czech Republic, Hungary, Serbia, Bosnia, Kosovo, Montenegro, Moldova, Ukraine, etc) create a multi-national retail sales network; the largest in South-East Europe for building materials.



# certifications

www.metronsa.eu



Since 2000 **METRON** has applied a quality management system according to the **EN ISO 9001:2000** standard. All **METRON** products bear the **CE** of **European Union** quality certification. Production lines are programmed and controlled by **MRP** and **ERP** software.



All **Metron** Lifts are designed according to the **European Directive 2017/33/EU** and conform to **European Standard EN81.20**. In addition, lifts are designed in compliance with the following more specific categories:

- EN 81.70 Disabled People
- EN 81.28 Rescue Operation
- EN 82.21 Existing Building

**Metron** also possesses the **Module H1** certificate which secures the outmost quality control for the *Design, Manufacturing, Installation and Certification of every lift.*



# Metron

## Passenger Lifts

Hydraulic Lifts

Traction Machine Roomless (MRL)

Traction with Machine Room



## Passenger Lifts Metron

[www.metronsa.eu](http://www.metronsa.eu)

Key factor in order to make the most suitable choice is to understand the main characteristics of an elevator system. Choose your elevator according to the number of floors, the usage frequency and of course the available budget. The best choice is the one that responds to your specific needs.

### HYDRAULIC LIFTS:

Ideal choice for low or residential buildings (up to 6 floors), with low installation cost. The system uses oil pressure and it is highly suggested for residential usage.

comparatively higher installation cost, traction lifts are the most suitable solution because of their high speed, advanced technology and low energy consumption.

### TRACTION LIFTS WITH OR WITHOUT MACHINE ROOM:

Usually selected for multi-floor and high rise buildings or shopping malls with high usage frequency. Technologically state-of-the-art, besides the

Exploit Metron's know-how and purchase an elevator of high quality and safety. Metron can provide you solutions for each case, even in situations where there is no shaft by constructing a metallic frame on the external surface of your building.

## Hydraulic Lifts

### Basic Model

Load/Capacity	300 to 1600 kgr (4 to 21 person)
Maximum Speed	0,75 m/sec
Maximum travel	21 m
Maximum floor served	8
Valve	Bucher
Door Type	Metron Doors
Cabin Type	Metron Cabins

# Hydraulic Lifts

www.metronsa.eu

## Oilers

ETN - Germany

## Pump

Settima - Italy

## Motor

ELMO - Italy

## Hydraulic Valves

Blain - Germany  
Bucher - Switzerland

## Piston

Omar/Wittur - Italy

## Guiderails

Marazzi - Italy

## Shoes

ETN - Germany



# Hydraulic Lifts

4 - 21 persons   300 - 1600 kg   32 stops   Travel: 24 m   Pit: 545m   Head: 2.867 m

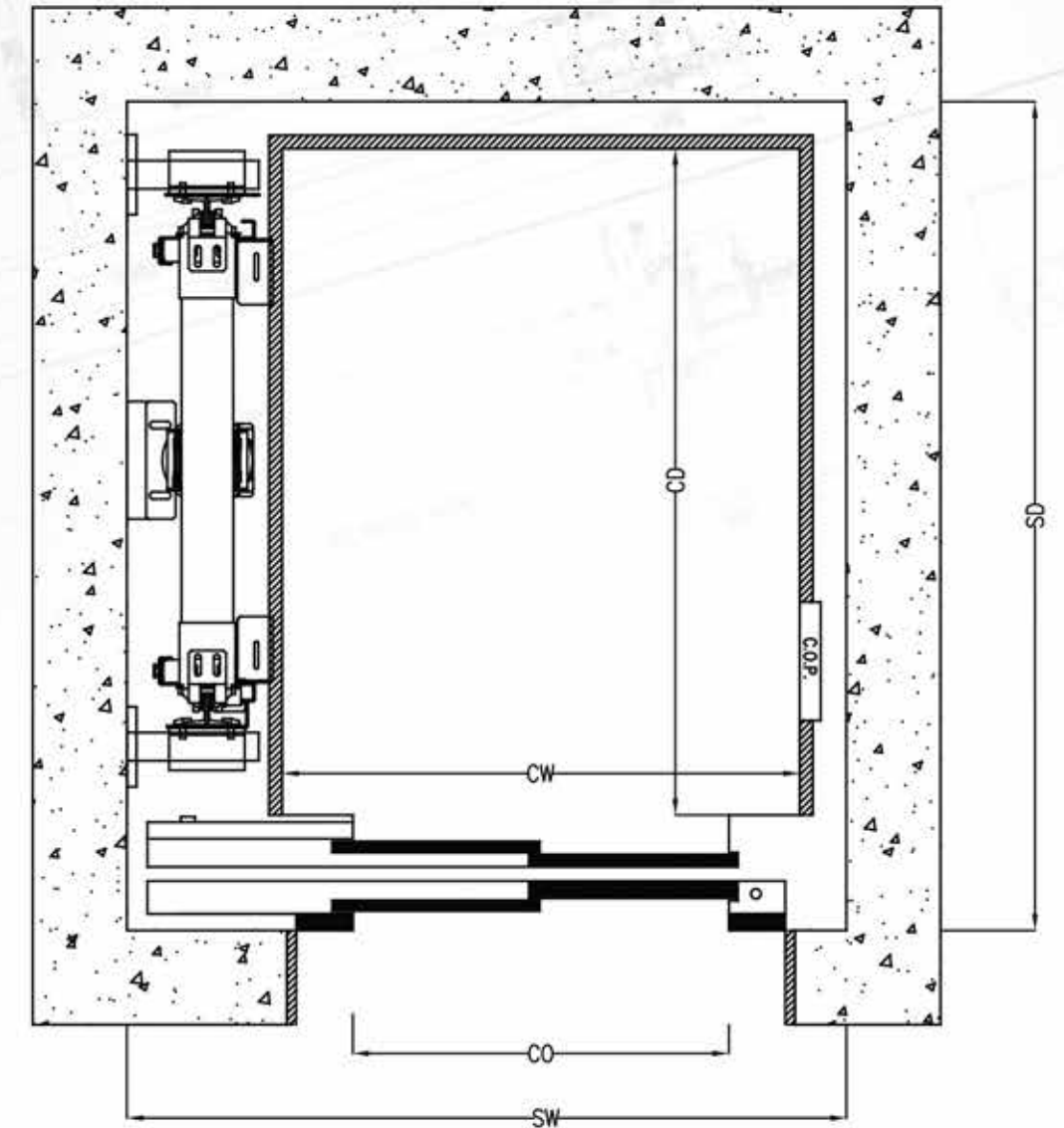

Persons/Load	Shaft Width	Shaft Depth	Cabin Width	Cabin Depth	Door Opening
4/300 kg	1250	1300	850	950	700
6/450 kg	1550	1500	1100	1150	900
8/630 kg	1550	1750	1100	1400	900
13/1000 kg	1850	2050	1400	1700	1100
21/1600 kg	2200	2450	1650	2100	1200

Technical specifications are subject to change without notice.



# Machine Roomless Traction Lifts

www.metronsa.eu

## Metron MRL

Load/Capacity	300 to 2000 kgr (4 to 26 person)
Maximum Speed	2 m/sec
Maximum travel	90 m
Maximum floor served	32
Door Type	Metron Doors
Cabin Type	Metron Cabins

### Metron machine roomless traction lifts (MRL):

- Do not require increased shaft dimensions.
- Integrate the latest technologies for reduced energy consumption.
- Have low maintenance requirements.
- Integrate state-of-the-art electronics.
- Have high aesthetics design.
- Conform to European Standards EN81.20, EN81.21, EN81.70 and EN81.28.

...and has been totally designed by Metron people

## Machine Roomless Traction Lifts

### Speed Governor **Dynatech-Spain**

- (+) top safety level
- (+) quick availability of spare parts

### 6.5mm Ropes **Gustav Wolf - Germany**

- (+) minimum motor pulley
- (+) minimum lengthen over time

### Guide Shoes **ETN-Germany**

- (+) reduced noise inside the cabin
- (+) comfort and ride quality for the passengers

### Metron Gearless Motor in partnership with **Lafert-Italy**

- (+) highly experienced manufacturer
- (+) KEB disk brake
- (+) heidenheim encoder

### Safety Gear **Dynatech-Spain**

- (+) easy installation
- (+) after braking no need for readjustment

### Buffers **ETN-Germany**

- (+) highest safety
- (+) top brand name



4 - 13 persons 300 - 1000 kg 16 stops **Travel:** 45 m **Pit:** 1.150m **Head:** 3.350 m

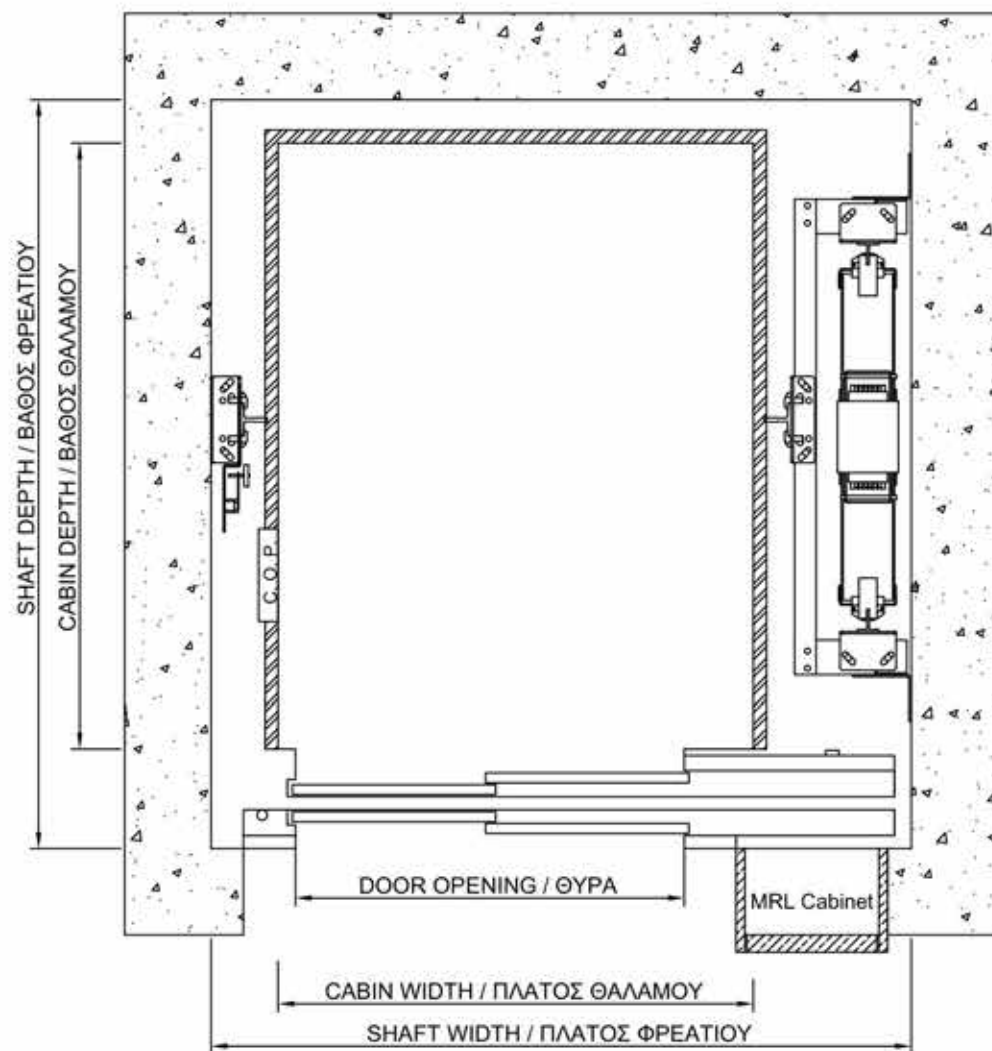

**MRL G STARTER**

Persons	Rated Load	Cabin Dimensions			Shaft Dimensions	
		Cabin Width	Cabin Depth	Door Opening	Shaft Width	Shaft Depth
4	300	850	1050	700	1320	1350
6	450	1000	1300	800	1500	1600
8	630	1100	1400	900	1600	1700
10	750	1300	1400	900	1800	1700
13	1000	1400	1700	1000	1940	2000

Technical specifications are subject to change without notice.

## Traction Lifts with Machine Room

[www.metronsa.eu](http://www.metronsa.eu)

### Metron Traction

Load/Capacity	300 to 1600 kgr (4 to 21 person)
Maximum Speed	1,6 m/sec
Maximum travel	75 m
Maximum floor served	32
Door Type	Metron Doors
Cabin Type	Metron Cabins

- Reduced acquisition and maintenance cost
- Outstanding ride quality
- Precise leveling accuracy according to the EN81-1/A3 standard
- Reduces energy consumption and installed power with use of VVVF inverter
- Complete lift system
- Full shaft drawings and detailed installation, operation and maintenance manuals
- Adaptability at shaft dimensions
- Conforms with directives EN81-1, EN81-70 & EN 81-28

#### Guide Shoes

ETN - Germany  
ETV

#### Oilers

ETN - Germany  
ETV

#### Safety Gear

Dynatech- Spain

#### Geared Machine

Alberto Sassi - Italy  
ETV





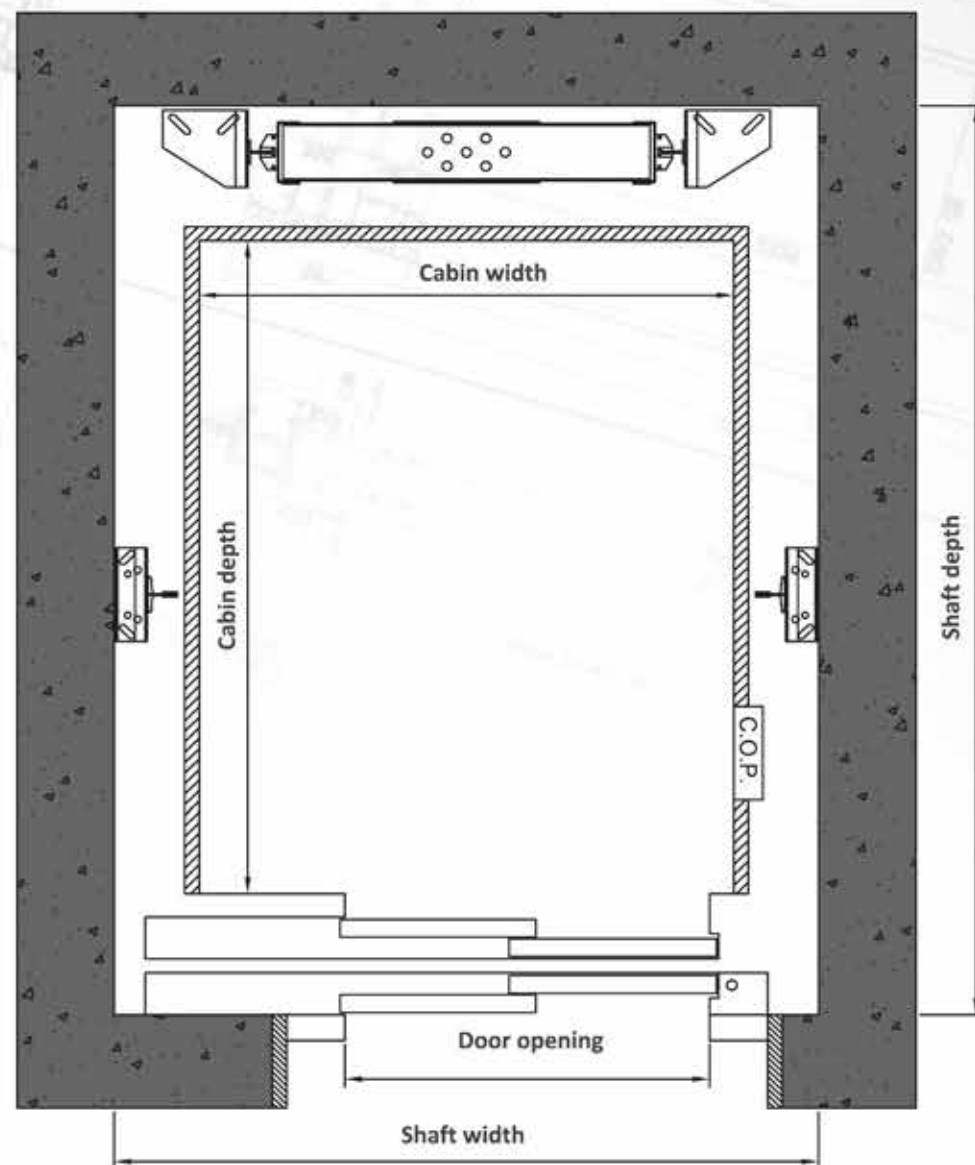

## Home Lifts HABITAT

When choosing a lift for your house, you are choosing your own elevator, the one that will always operate there.

That's why we, in Metron, are working in order to ensure the smooth and reliable function of your elevator, combined with a flawless aesthetic result. We provide solutions with a great variety of choices in patterns, colours and materials, in order to make a unique lift for you.

Persons / Load	Sling type	Min Headroom (mm)	Min Pit (mm)	Clear cabin dimensions (mm)		Shaft dimensions(mm)		Door opening CO (mm)
				Width CW	Depth CD	Width SW	Depth SD	
4/300 kg	CS 27	3070	860	900	1000	1250	1550	650
6/450kg	CS 27	3070	860	1100	1150	1450	1700	750
8/630kg	CS 813	3110	860	1100	1400	1500	1950	800
13/1000kg	CS 813	3110	860	1350	1700	1800	2250	1000
21/1600kg	InCS 1426	3050	700	1400	2400	1900	3000	1000

Technical specifications are subject to change without notice.



## Metron Home Lifts - HABITAT

www.metronsa.eu

### Lift Solution

Load/Capacity	Up to 300 kgr (4 persons)
Maximum Speed	0,5 m/sec
Maximum travel	10 m
Maximum floor served	4
Valve	Bucher
Door Type	Metron Doors
Cabin Type	Metron Cabins
Low Pit	200mm
Low Headroom	2500mm

### Machine Directive

Load/Capacity	Up to 300 kgr (4persons)
Maximum Speed	0.15 m/sec
Maximum travel	9 m
Maximum floor served	4
Door Type	Metron Doors
Cabin Type	Metron Cabins
Low Pit	120 mm
Low Headroom	2600 mm

\* Single Phase solution is available



## HYDRAULIC HABITAT

### Advantages

- Maximum Cabin Size
- Low acquiring and installation cost
- Single-phase power supply

### Product Characteristics

- Hydraulic Valve: Blain
- Certified according to EN/ Machine Directive
- Available with all Metron Cabins

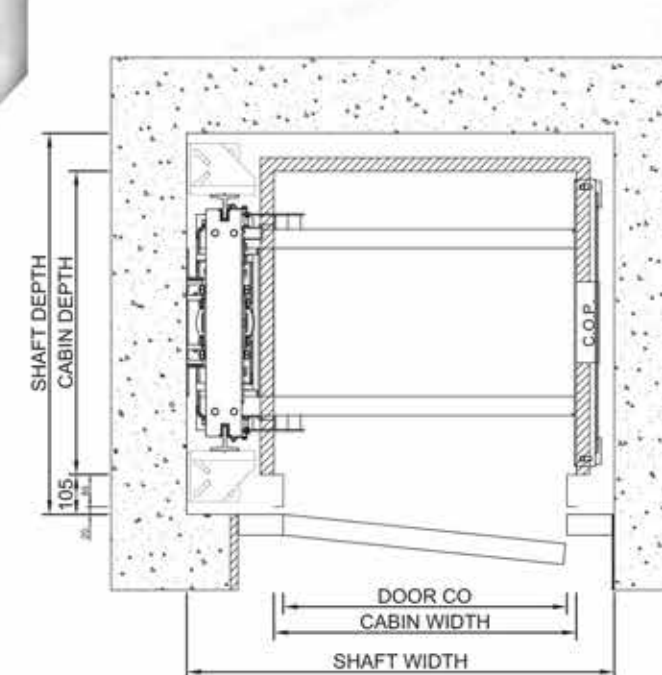

### Range of application

Max Rated Load (kg):	300	400
Speed (m/s):	0,15 m/s	
Stops:	8	
Max. Travel (m):	9 - 12m	
Min Pit Depth (mm):	120	140
Min Headroom (mm):	2500	2650
Max Motor Power (kW):	1.5	2.2
Max Cabin Dims:	800x1300	1100x1400

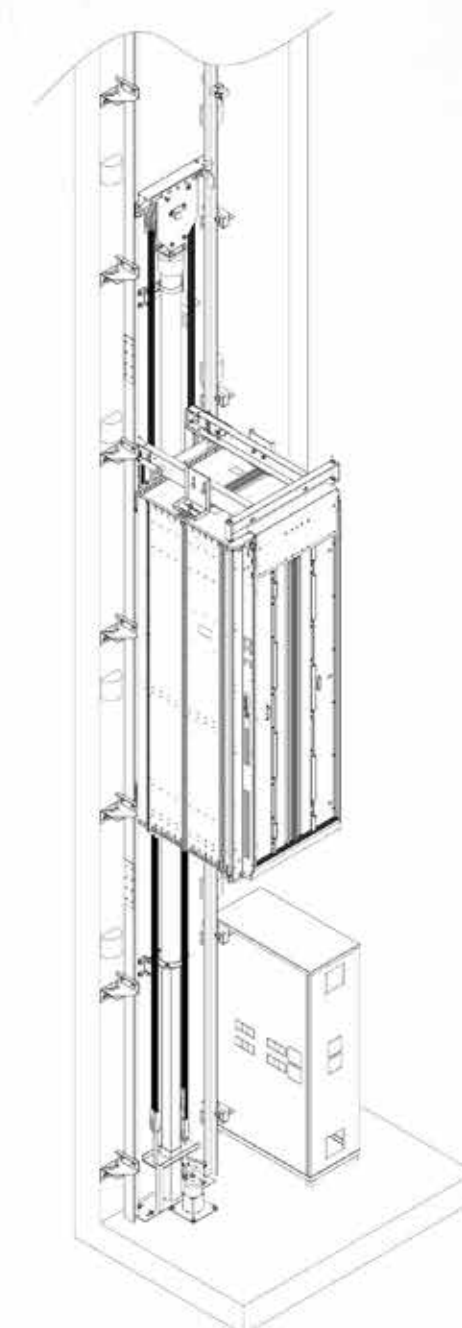

Technical specifications are subject to change without notice.



## Cabinet for Hydraulic Machine Roomless Solution

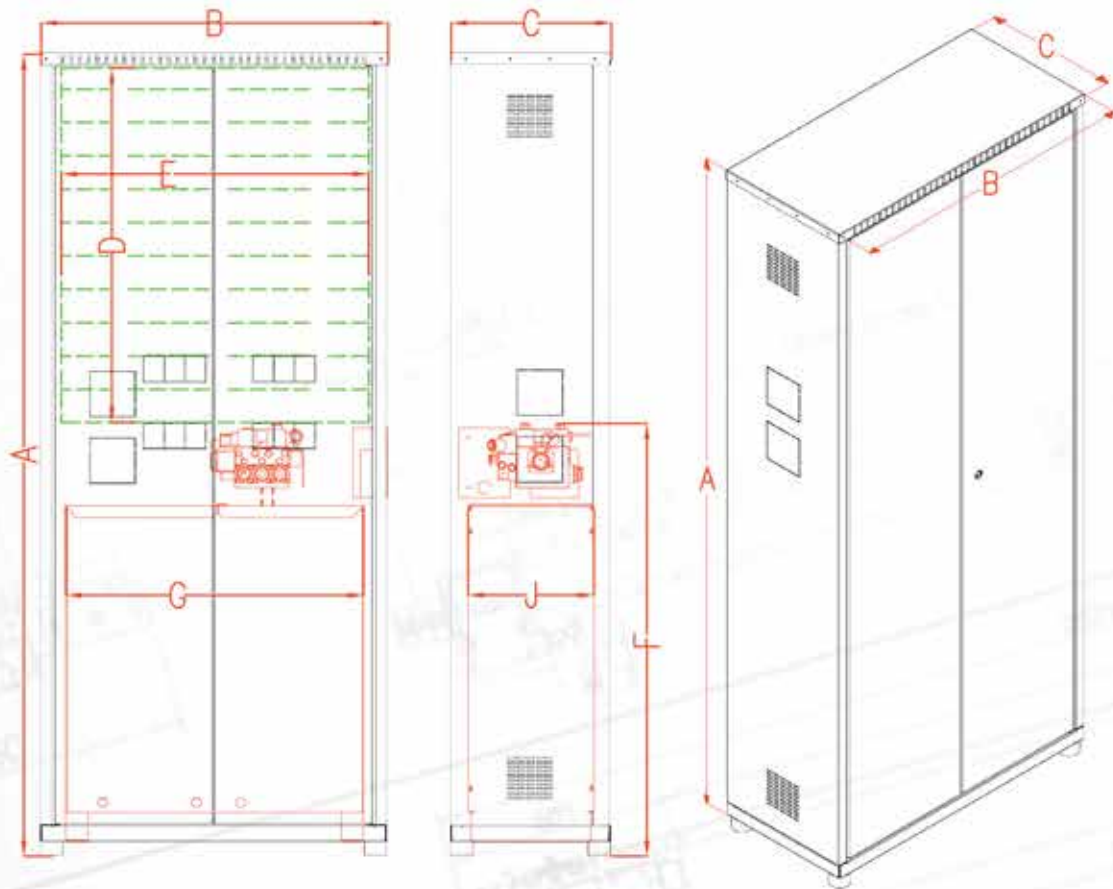

Metallic Shaft

Cabinet Type	Cabinet Dimensions (mm)			Oil Tank Type	Max Motor Power (KW)	Max Work Capacity (L)	Oil Capacity (L)		Oil Tank Dimensions (mm)				Control Panel Dimensions (mm)		
	A	B	C				Vmin	Vmax	F VALVE 3/4	F VALVE 1 1/2	G	J	E	D VALVE 3/4	D VALVE 1 1/2
R1	2000	780	360	UR1-100	6-11	100	40	140	1130	1200	669	260	726	861	791
R2	1800	800	400	UR2-100	8-13	100	45	145	1040	1110	689	320	746	751	681
R3	2100	930	470	UR3-200	8-20	200	75	275	1250	1320	819	390	876	841	771
R4	2100	1200	570	UR4-300	6-29	300	130	430	1170	1240	1089	490	1146	921	851



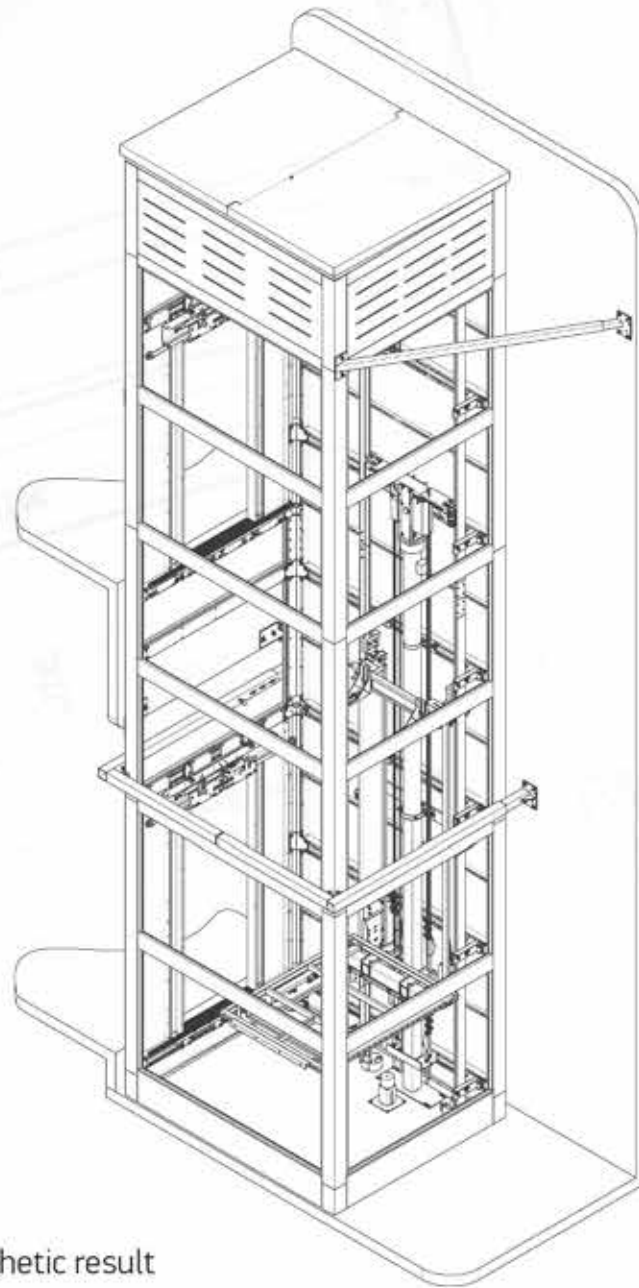

- Top class aesthetic result
- Powder-coating in the range of Metron Colours Collection
- Variety of external facing: metal sheet painted in Metron Colours or glass
- Full technical documentation
- Suitable for indoor and outdoor installation
- Compatible with every Metron's complete system of hydraulic and MRL traction lifts
- Suitable for elevators up to 4 stops and 8 persons
- Production capability in any width x depth combination



## Cargo and Car Lifts

A cargo lift should be characterized by high durability and functionality, even under the most difficult circumstances. This kind of elevators are usually installed either as parking systems or in industrial facilities for heavy loads' transfer.



### Specifications

Load/Capacity	Up to 5.000 kgr
Maximum Speed	0,3 m/sec
Maximum travel	12 m
Maximum floor served	5
Valve	Bucher
Door Type	Metron Doors
Cabin Type	Metron Cabins

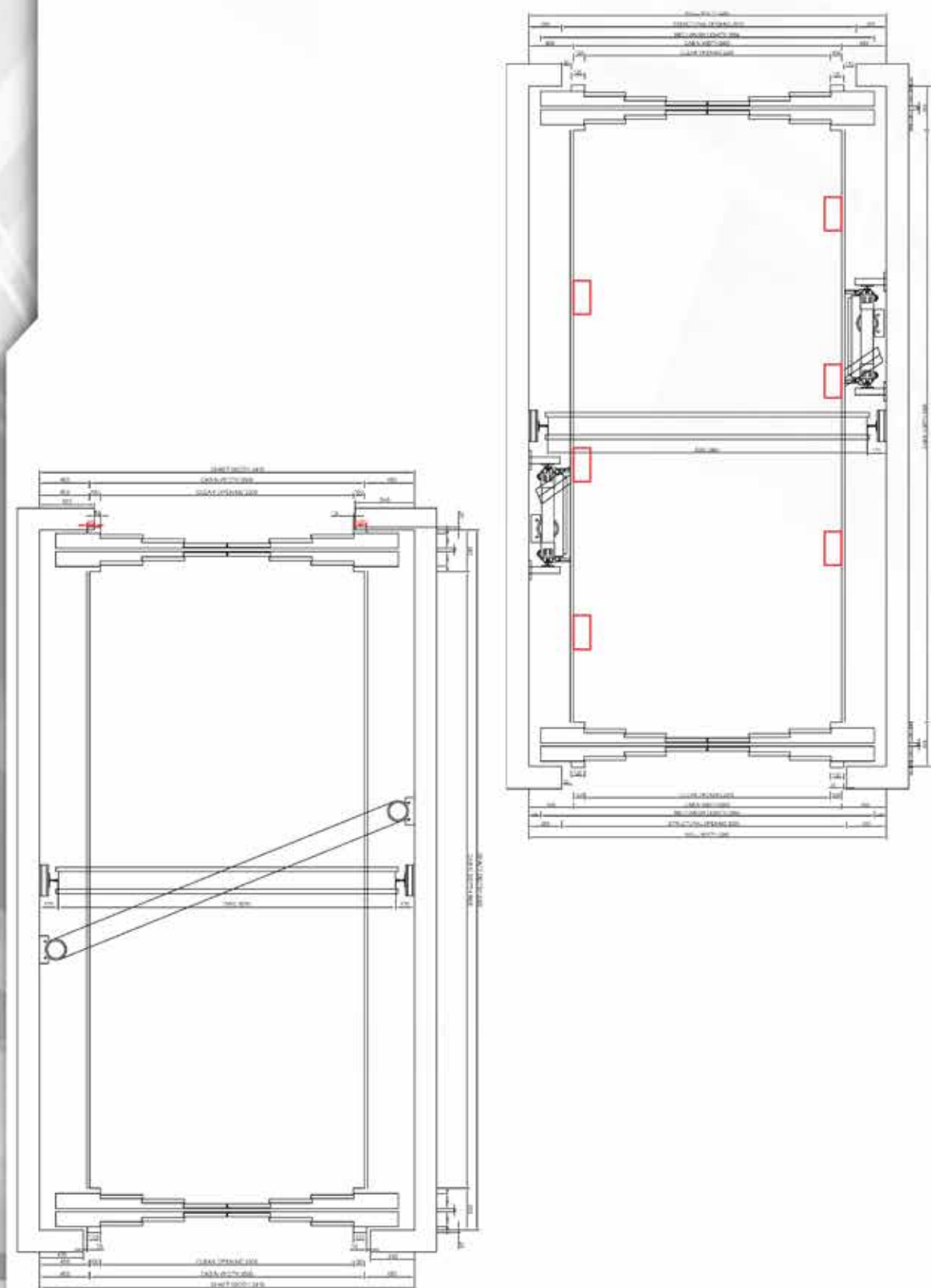



## Platform - Cargo Lift

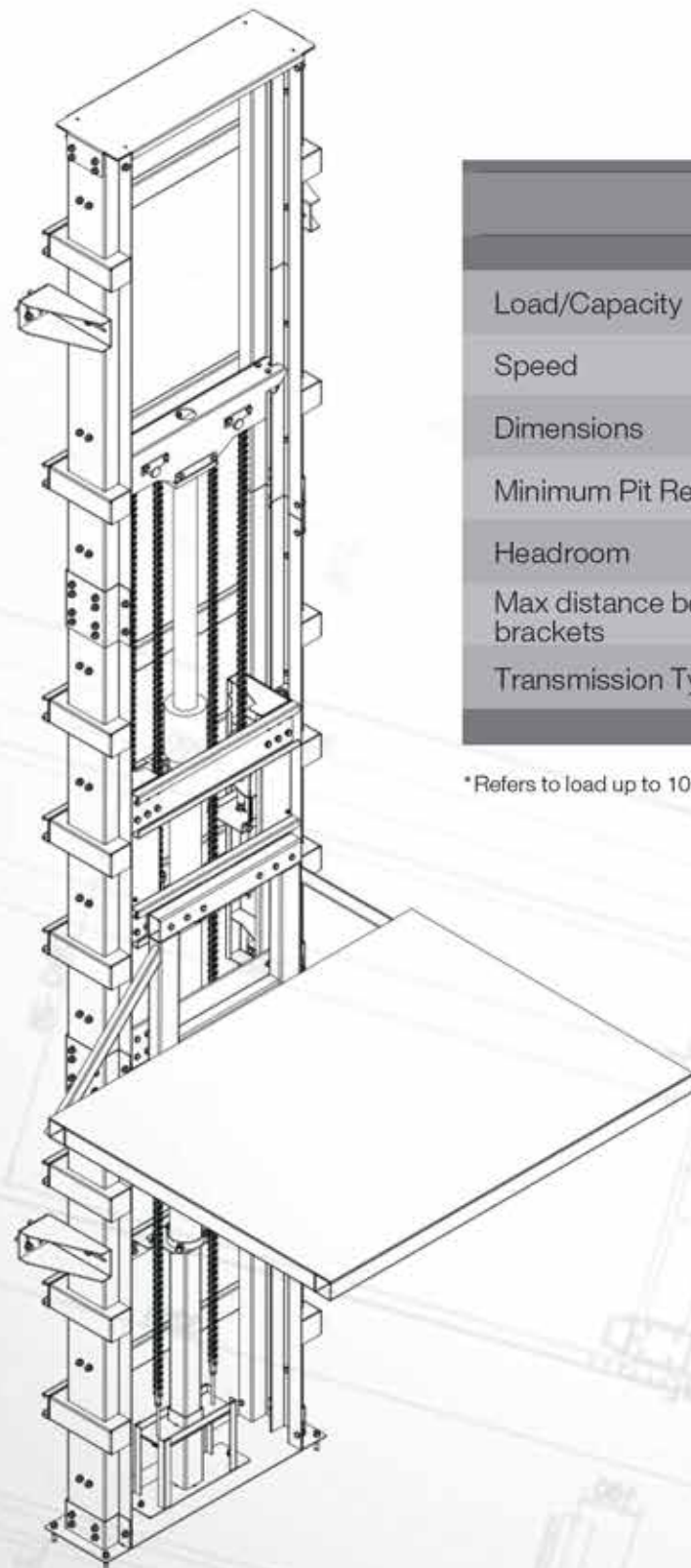

Specifications	
Load/Capacity	500 to 2000 kgr
Speed	0.15 m/sec
Dimensions	1800 x 1400 (W x D mm)
Minimum Pit Required	150mm*
Headroom	1500mm
Max distance between brackets	4m*
Transmission Type	2 Chains *

\*Refers to load up to 1000 kg

## Dumbwaiters

Specifications	
Load/Capacity	5-300 kg
Type	Traction MRL
Speed	0,2 -1 m/sec
Cabin Dimensions	350x350x600 -1000x1000x1200 (WxDxH mm)
Max Travel	120m
Cabin Entrances	1-3

Compliance with Machine Directive 2016/42/CE & EN 81.3

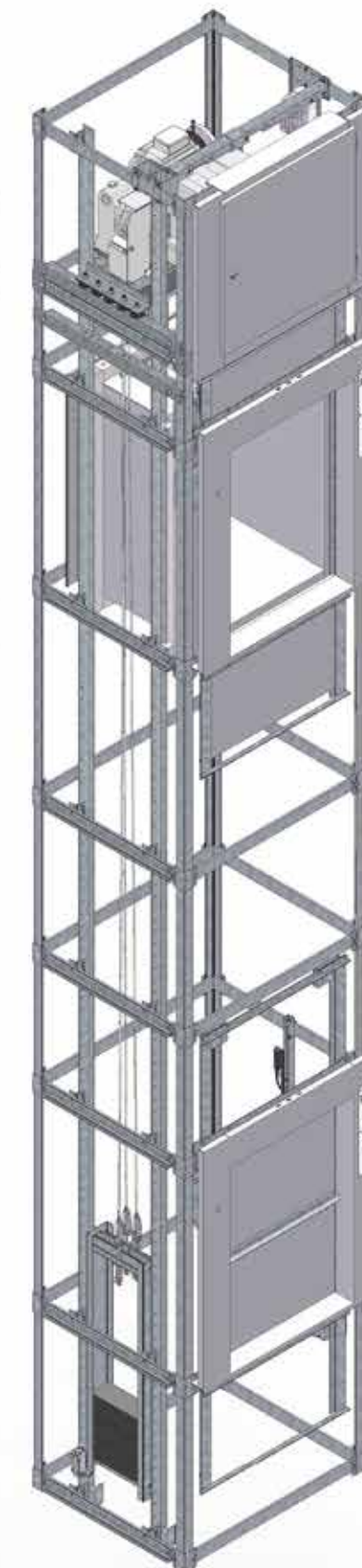



## Escalators and Moving Walks

[www.metronsa.eu](http://www.metronsa.eu)

Metron responding to the increasing needs of its customers, has developed a complete series of escalators and moving walks. Our range can meet the requirements of the most demanding project around the world both in a technical and in an aesthetic way.



## Metron | Cabins

City Life | Life Desire | Pure Life | Life Shine | Life Light







## City Life

Cabins from City Life series constitute an ideal solution for those who want to combine materials and colours at the best possible value. Every City Life cabin is a robust structure, which ensures durability over time, while it is available in every colour combination from Metron Colours Collection.

City Life  
corporate

**31**  
**metron**  
Engineering for Life  
Alumal Group

## Colour Up

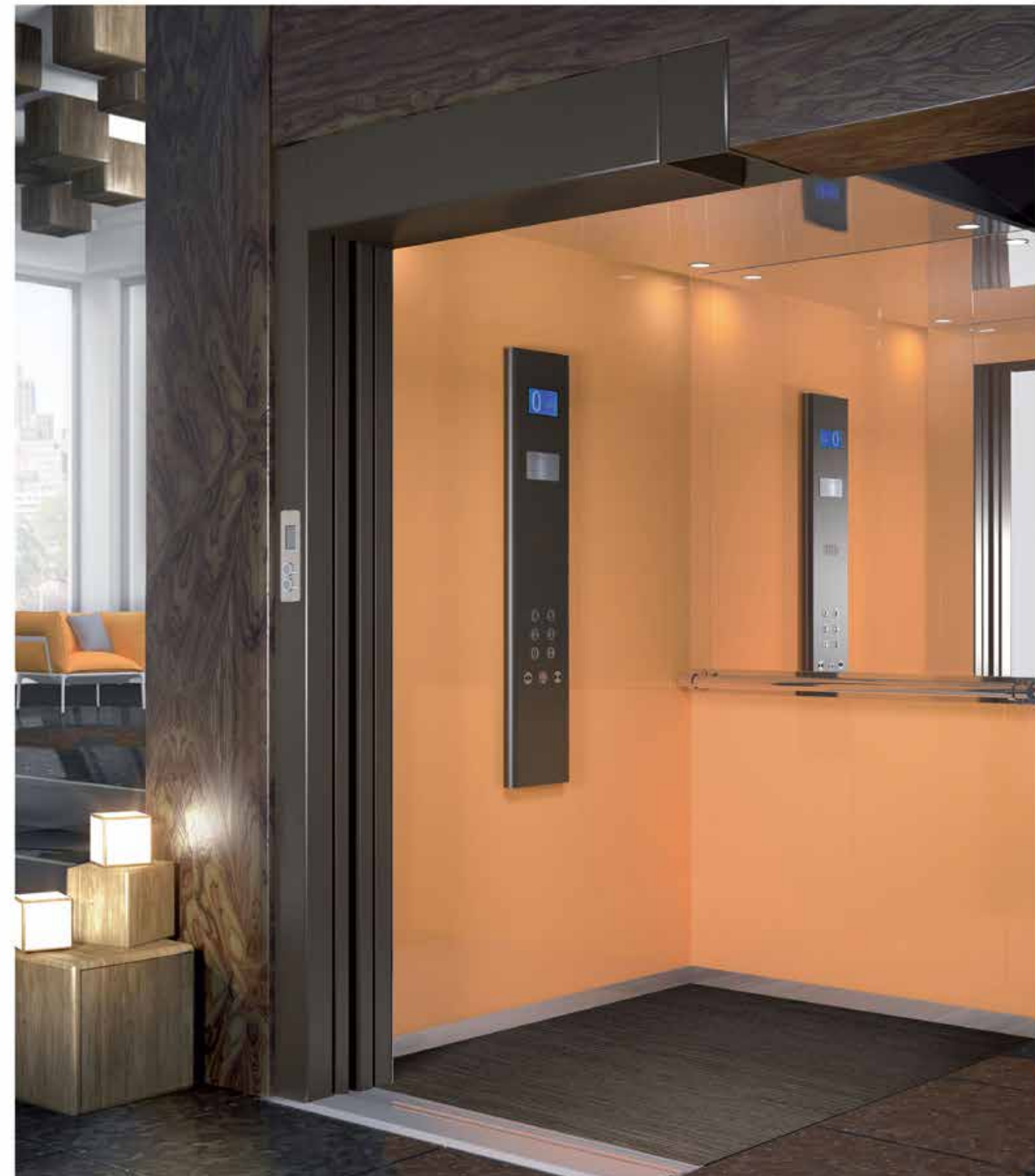





1. Tempo HB
2. Silva HB
3. Silva Inox



## Life Desire

Life Desire cabins are the "diamonds" of Metron cabins series. Absolutely exceptional and absolutely characteristic cabins that put into practice Metron's declaration from the first moment it entered the market in 1995. Cabins that make the surrounding environment more beautiful, while at the same time they are completely affordable solutions.

## Moon



## Prestige Deluxe



## Luminous







1. Master
2. Twist
3. Colour Up Deluxe



1  
3 2



## Pure Life

Metron series of panoramic cabins Pure Life catches the eye wherever it is installed. Cabins of high aesthetics and durability that travel their passengers through space.



## Panoramic



## Life Shine

Metron cabins from the Life Shine series are here to change your mind about inox cabins. Enough with "cold" cabins that are nothing more than metallic boxes moving up and down. A Metron Life Shine cabin is characterized by distinctive aesthetics and incomparable quality.



# Essence



1. Tempo Inox
2. Illusion
3. Elite





## Leaf

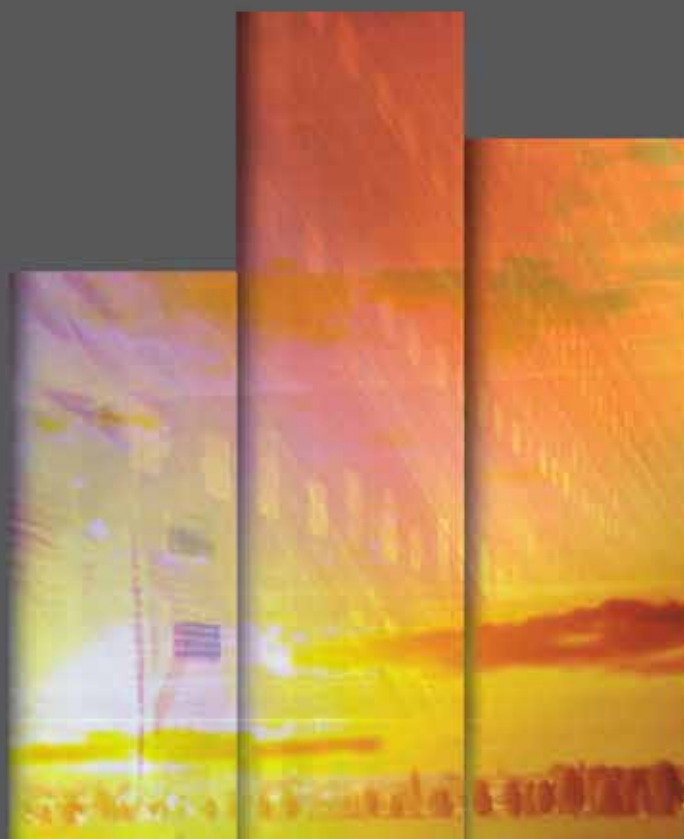

## Life Light

The new Life Light cabin series is the result of combining two principal materials of a lift cabin, light and colour. We wanted to use these two elements in a radically different way compared to the current usage in the lift sector.





## Ribbon



## Metron | Lift Door Models

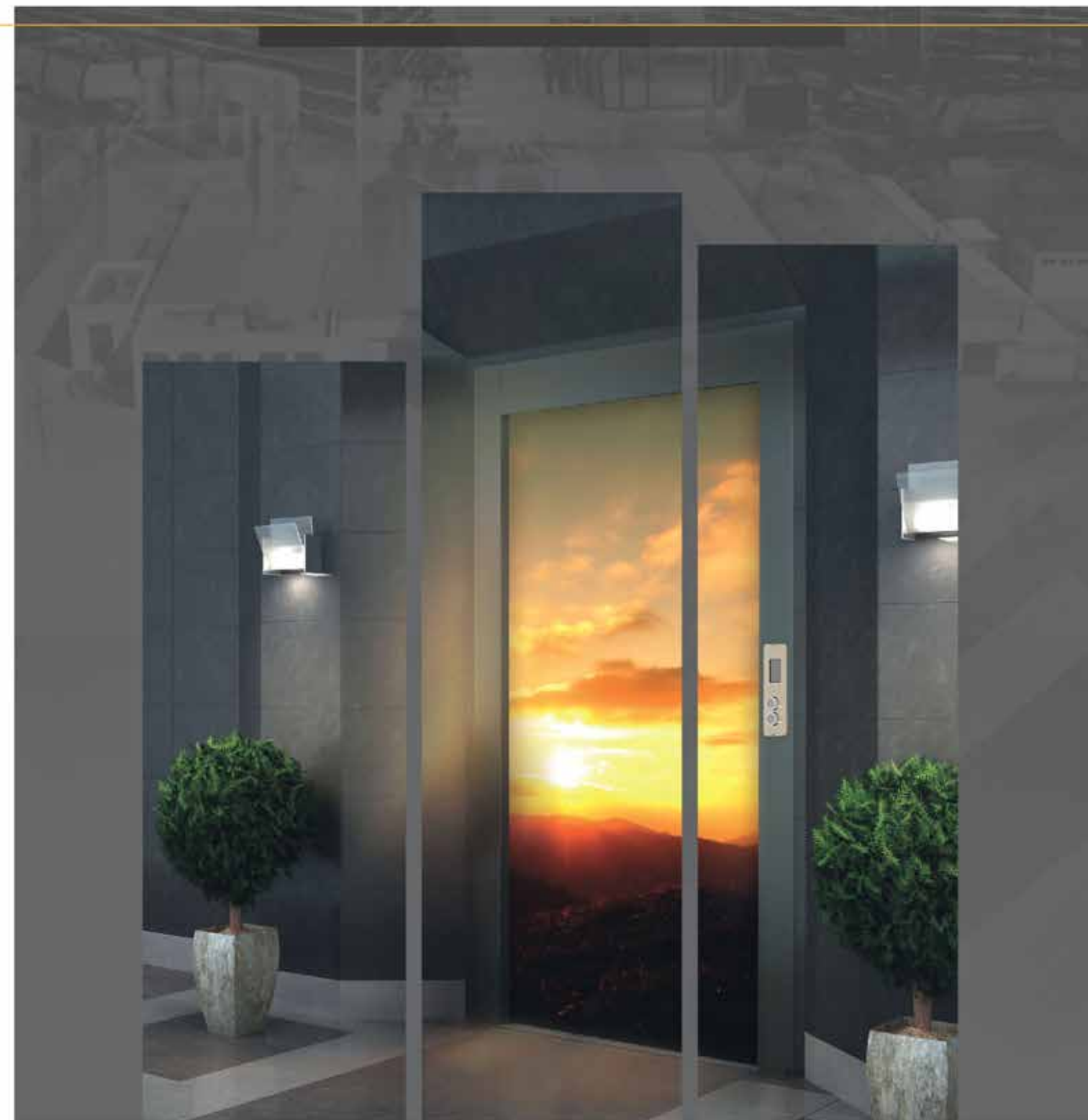







1  
2 3



1 2  
3 4





# Metron | References

Metron References  
corporate



## Mayol Stadium, Toulon



Panoramic Powder Coated Machine Roomless (MRL) Lift



France





## La Major - Jardin Vaudoyer



Panoramic Powder Coated Machine Roomless (MRL) Lift



France



## Cogolin Peirin Residence



3 Machine Roomless (MRL) Lifts



France





## City Hall in Szczecinek



External Panoramic Machine Roomless (MRL) Lift



Poland



## Painted Shaft in Leszno



Hydraulic Panoramic Lift



Poland





## Residence Katowice



Hydraulic Panoramic Lift in the staircase



Poland



## Hadeland Glassverk Factory



Machine Roomless (MRL) Lift



Norway





## External Shaft Valetta



Hydraulic Panoramic Lift



Malta



## Civil Defense - Jebel Ali Center



Hydraulic Panoramic Lift



U.A.E





## Al Nahda School Abu Dhabi



Double Entrance Hydraulic Lift



U.A.E



## Double Tree hotel by Hilton Tyumen



4 Machine Roomless (MRL) Lifts



Russia





## Footbridge Moskva River

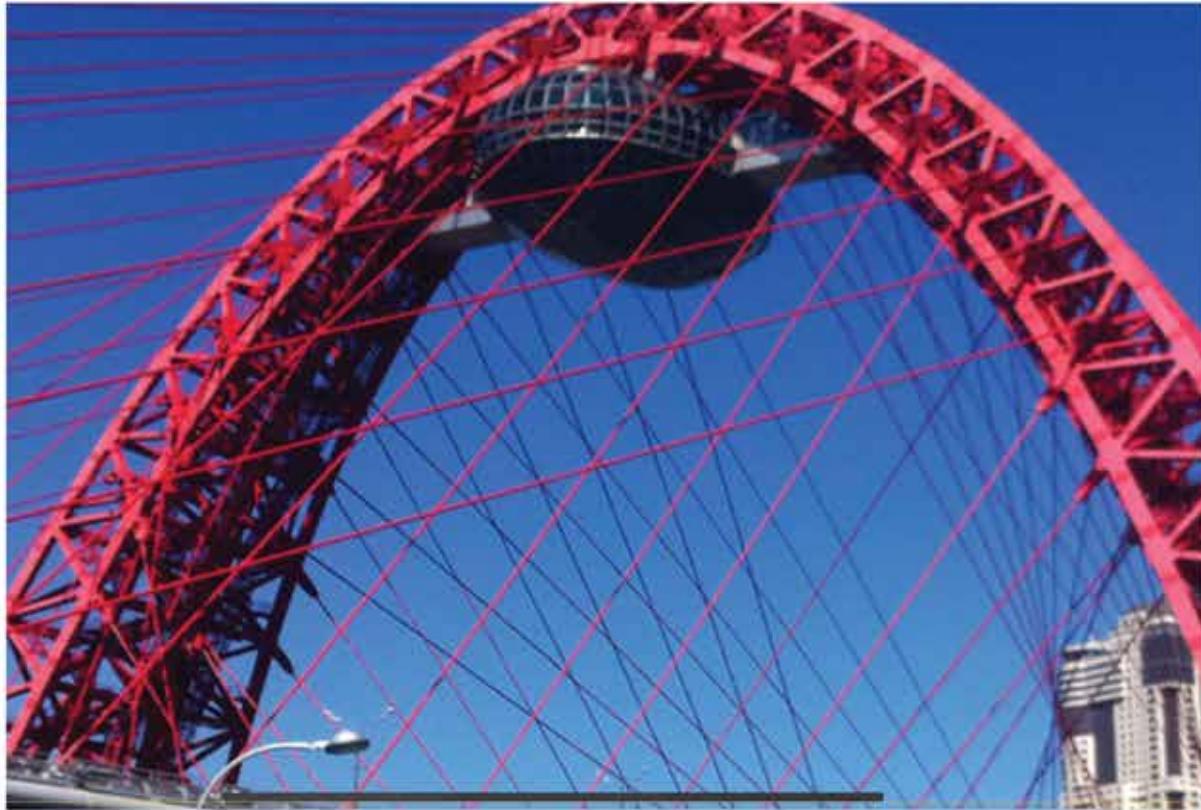

Hydraulic Panoramic Lifts

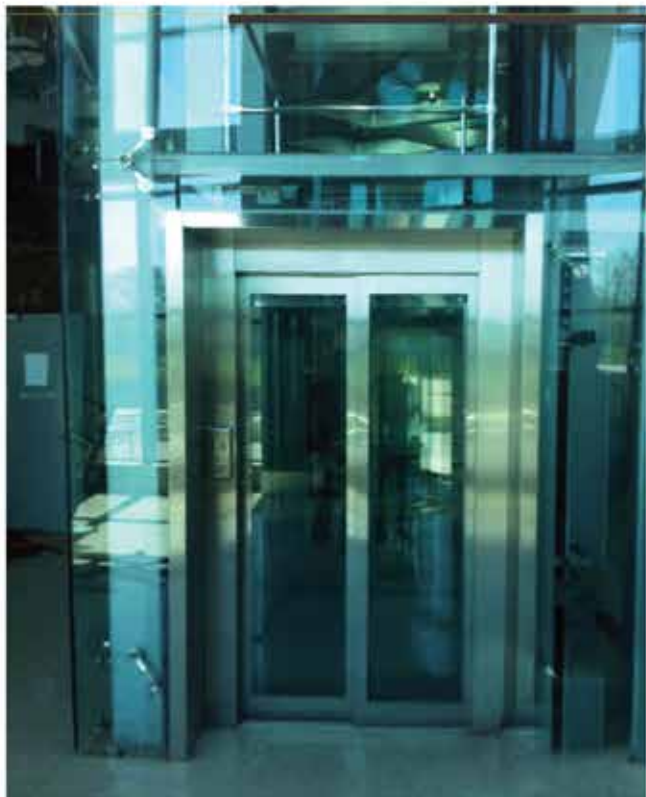

Russia



## Wedding Hall



Double Entrance Hydraulic Panoramic Lift



Kazakhstan





## Winecellar in Toplicki



Hydraulic Cargo Lift



Serbia



## Andrićgrad Cultural Center



Hydraulic Stainless Steel Panoramic Lift



Bosnia





## Kunina External Metallic Shaft



Hydraulic External Lift



Croatia



## Residence in Budapest



Hydraulic Panoramic Lift



Hungary





## Hotel Aridolf



Machine Roomless (MRL) Lift



Nigeria



## Residence in Larnaca



Residential Machine Roomless (MRL) Lift



Cyprus





## Hotel Liro



Hydraulic Lift



Albania



## Ilion School



Hydraulic Lift



Greece





## Blue Lagoon Resort Kos



7 Powder Coated Hydraulic Lifts



Greece



## Bay Palace Kefalonia



External Hydraulic Stainless Steel Lift



Greece





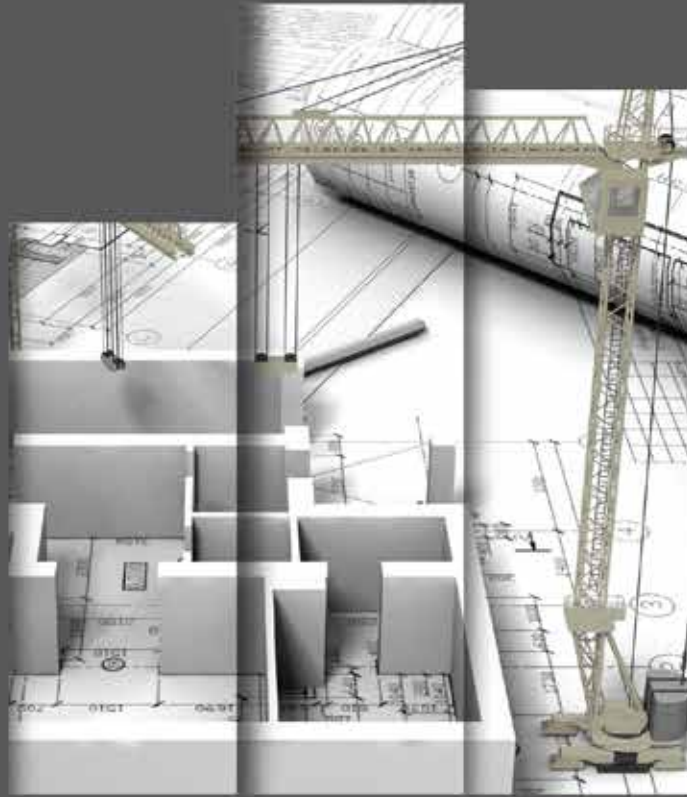

## Ongoing Projects

**metron**  
Engineering for Life

Ongoing Projects  
corporate

**75**  
**metron**  
Engineering for Life  
Atum Group

## City of Arabia



70 Machine Roomless (MRL) Lifts



U.A.E





## Residential Group of Buildings in Tyumen



81 Machine Roomless (MRL) Lifts



Russia



Kazakhstan



## Esentai City



240 Hydraulic Lifts





42 countries  
worldwide



**Metron** | Engineering for Life

[www.metronsa.eu](http://www.metronsa.eu)

**Alumil Group**

Since the beginning Metron paid particular attention to the exports, initially in Balkan and European countries and steadily in Russia, the Arabian Gulf, Africa and Latin America. What differentiated Metron among the competition and still is the main lever for

further development, is the reliability in every aspect. In terms of company, in terms of people and product. Today, Metron due to the dedication and perpetual effort of its employees around the world is present in 42 countries, in 4 different continents.

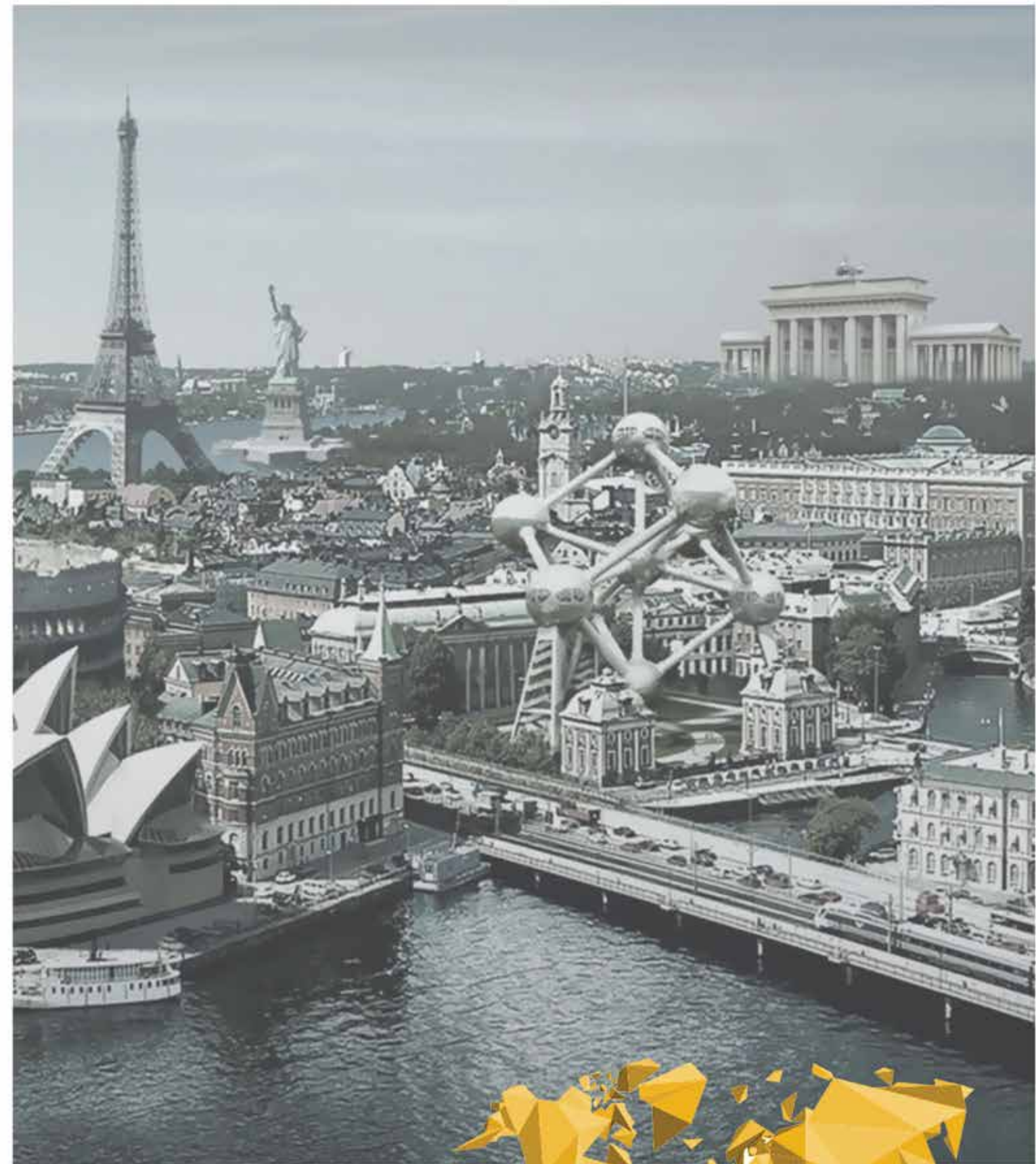

However, we do not mention just a number, what really matters the most is the trust and relation built with our partners in these countries. These honest and long-term collaborations secure both Metron's competitiveness and our partners' globally.





# Metron | Engineering for Life

| | [www.metronsa.eu](http://www.metronsa.eu)

**ALUMIL** Group

 [www.facebook.com/EngineeringForLife](https://www.facebook.com/EngineeringForLife)  [twitter.com/metronsa](https://twitter.com/metronsa)

 [www.linkedin.com/company/metron-sa](https://www.linkedin.com/company/metron-sa)  [info@metronsa.eu](mailto:info@metronsa.eu)